

1 0 1 0 2  
3 0 0 4  
a-L-b (+)

SPST  
CONTACT CONFIGURATION

NOTES:

1. ALL DIMENSIONS IN MM
2. GENERAL TOLERANCE: X.X=±0.4  
X.XX=±0.25
3. RATINGS: 5A @250V AC  
8A @125V AC
4. CONTACT MATERIAL:  
COPPER ALLOY W/Silver Plating
5. LAMP VOLTAGE: 48V AC/DC 25ma

PARTS LIST

| ITEM | QTY. | PART NO. | PART DESCRIPTION              |
|------|------|----------|-------------------------------|
| 1    | 1    | F040008  | D16 OA S1 1                   |
| 2    | 1    | F050406  | 50-004-06 (Incandescent bulb) |
| 3    | 1    | F052315  | 50-003-15 (OPAQUE WHT lens)   |

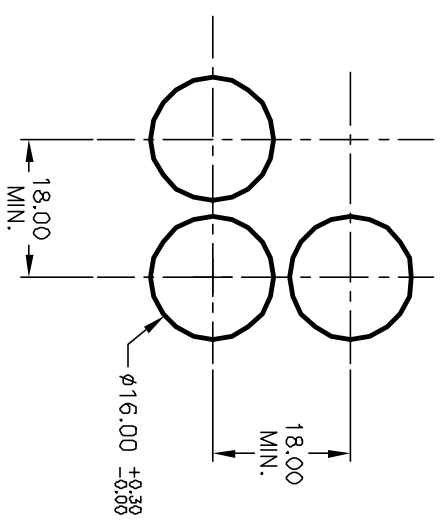

**E-SWITCH®**

| REV. | ECN No. | DESCRIPTION             | DATE    | CHKD |
|------|---------|-------------------------|---------|------|
| A    | 12160   | RELEASED FOR PRODUCTION | 5/21/02 | CJB  |

| TITLE  | SCALE | DATE    | DR | DWG     | REV |
|--|-------|---------|----|---------|-----|
| D16 OA S11 D WHT (Momentary)<br>OPAQUE/FLAT LENS | 1.5:1 | 5/21/02 | CB | XF0472P | A   |

THE INFORMATION CONTAINED IN THIS DOCUMENT IS PROPRIETARY TO E-SWITCH AND IS NOT TO BE COPIED OR TRANSFERRED